

K-125/K035 Shower Enclosure User's Guider

1. Mounting Preparation

- 1) After opening the carton, read this introduction carefully, check all the packed parts, and examine the shower cabin for shipping damage. If there is any problem, please contact the local seller or our company directly in time. You will get a satisfactory answer.
- 2) Necessary tools: drilling machine, stone drill (D=6mm), drill (D=3.0mm), cross strip, water level, meter stick, pencil.
- 3) With structured or imprinted glass make sure the smooth side of glass faces the inner side.

2. Packing list

- | | | |
|---------------------------------|------------------------------------|--------------------------------------|
| 1) plastic plugs (8pcs) | 2) wall connecting profiles (2pcs) | 3) M4X30 screws (8pcs) |
| 4) decorated cover (2pcs) | 5) 6x8 cushion for glass (2pcs) | 6) round cushion (4pcs) |
| 7) brass cushion (2pcs) | 8) plastic fixer (1pc) | 9) M4X10 screws (1pc) |
| 10) M6 screws (2pcs) | 11) front fixed glass door (1pc) | 12) rail (1pc) |
| 13) water proof strips (1pc) | 14) wheels (3pcs) | 15) sliding door (1pcs) |
| 16) handle (1pc) | 17) plastic strip (1pc) | 18) 4x8 cushion for glass (2pcs) |
| 19) plastic connector (1pc) | 20) M4X30 sunk screws (2pcs) | 21) plastic decorated cover (1pc) |
| 22) side fixed glass door (1pc) | 23) cover for screws (4pcs) | 24) M4X10 screws (4pcs) |
| 25) cushion (4pcs) | 26) fixer for glass door (1pc) | 27) aluminum water proof strip (1pc) |

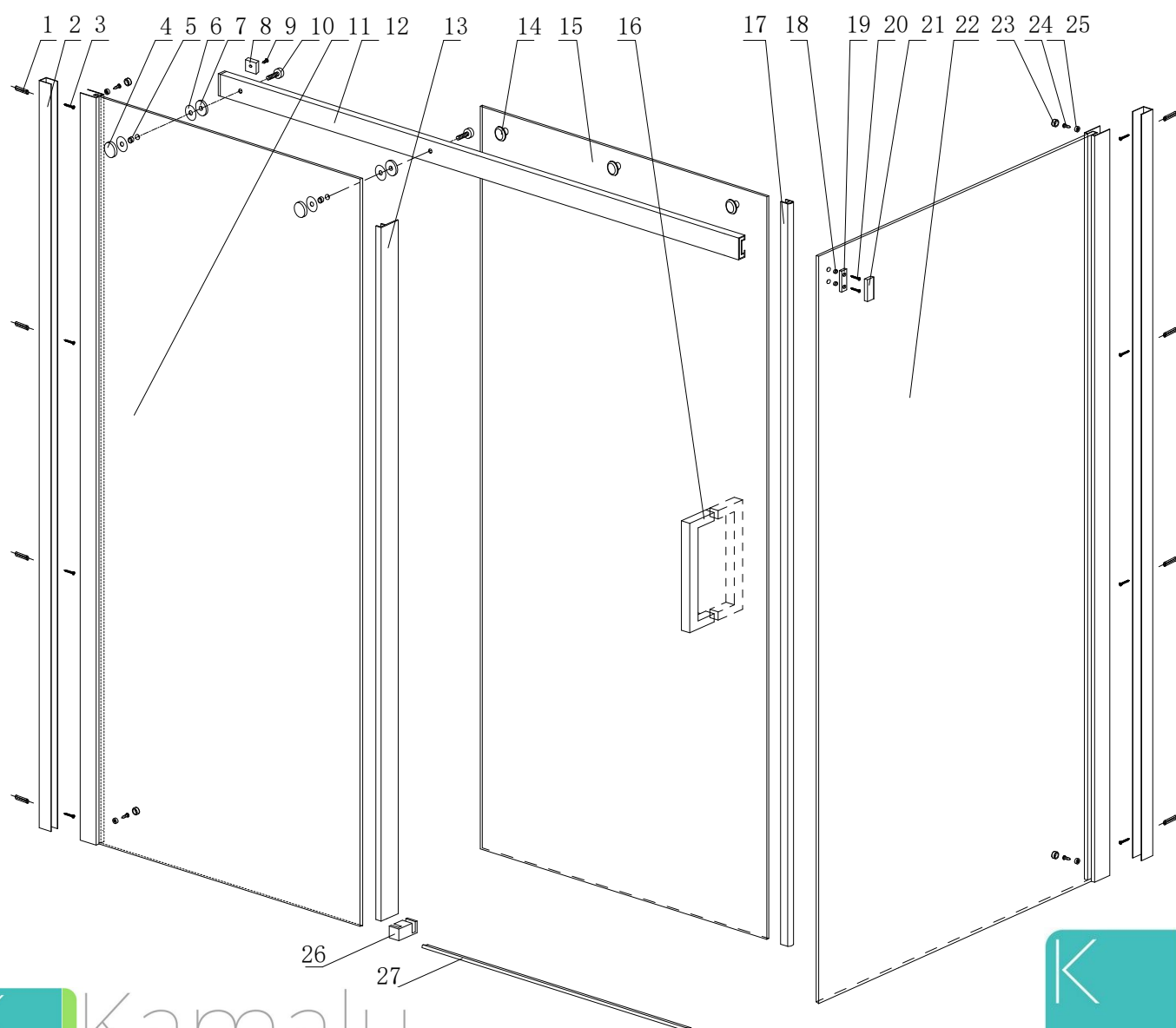

3) Mounting Process

- 1) Put the wall connecting profiles (2) on the wall or on the shower tray, adjusting the profiles to make sure it is vertical. Mark the holes on the wall. As Fig. 1
- 2) Drilling the holes (8-- $\phi 6\text{mm}$) according the mark, insert the 1) plastic plug into the hoes. As Fig.2

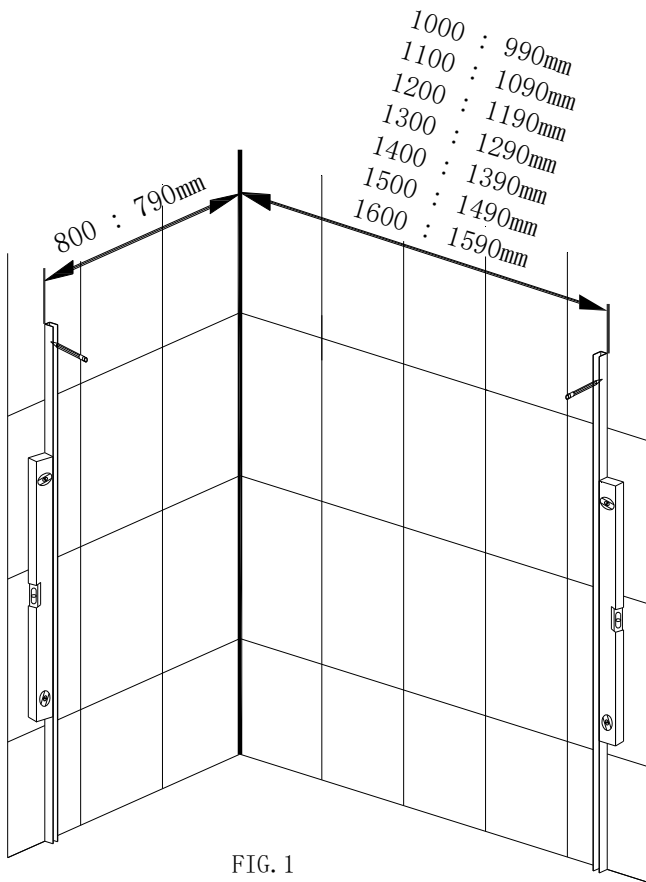

FIG. 1

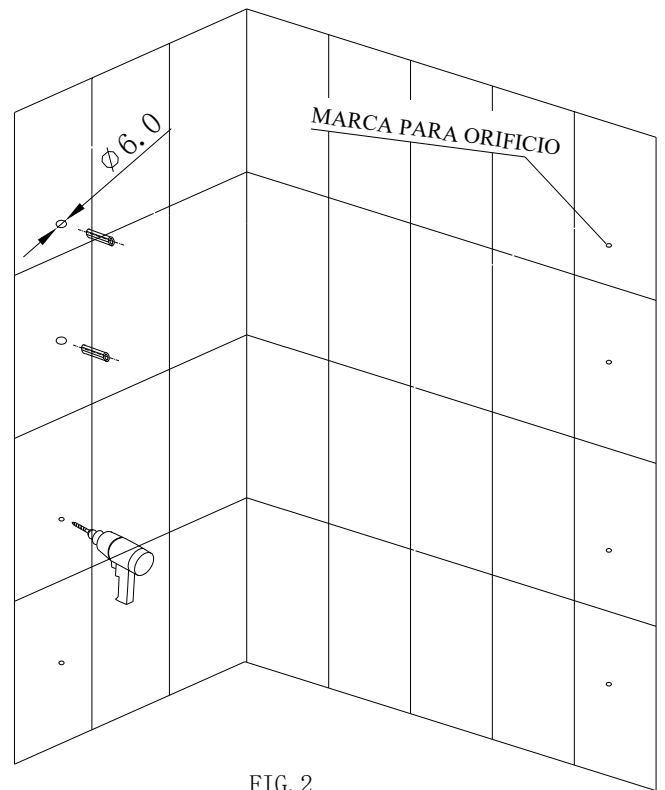

FIG. 2

- 3) Use the M4 x 30(3) to fix the wall connecting profiles (2). As Fig. 3
- 4) Connect the front fixed glass door (11) with left wall connecting profile. As Fig. 4

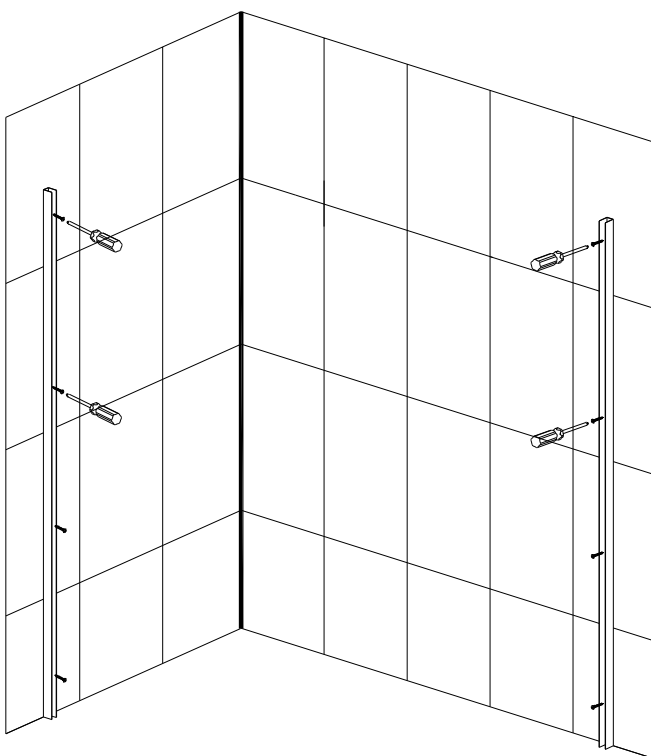

FIG. 3

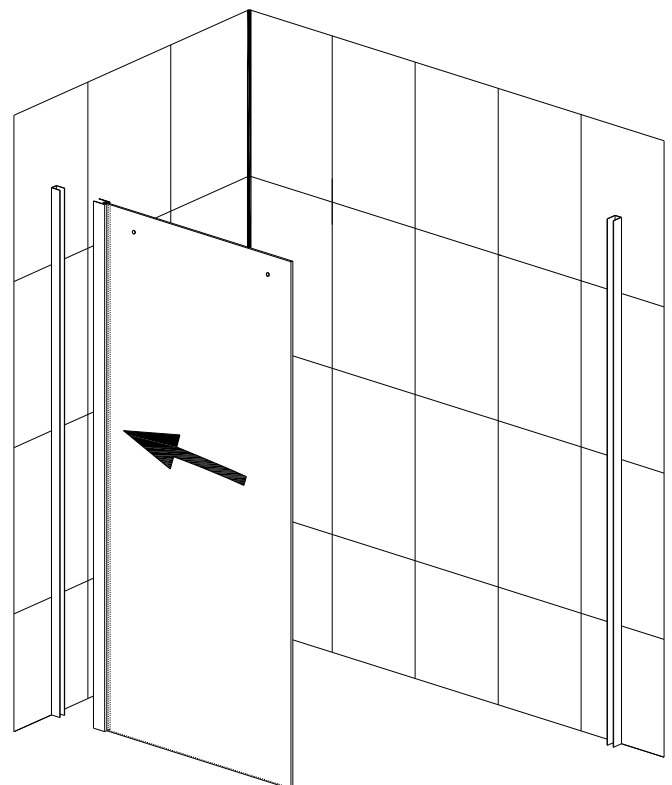

FIG. 4

- 5) Connect the rail (12) and the front fixed glass door (11). As Fig. 5
- 6) Fix the fixer for glass door (26) on the right of front fixed glass door (11). As Fig. 6

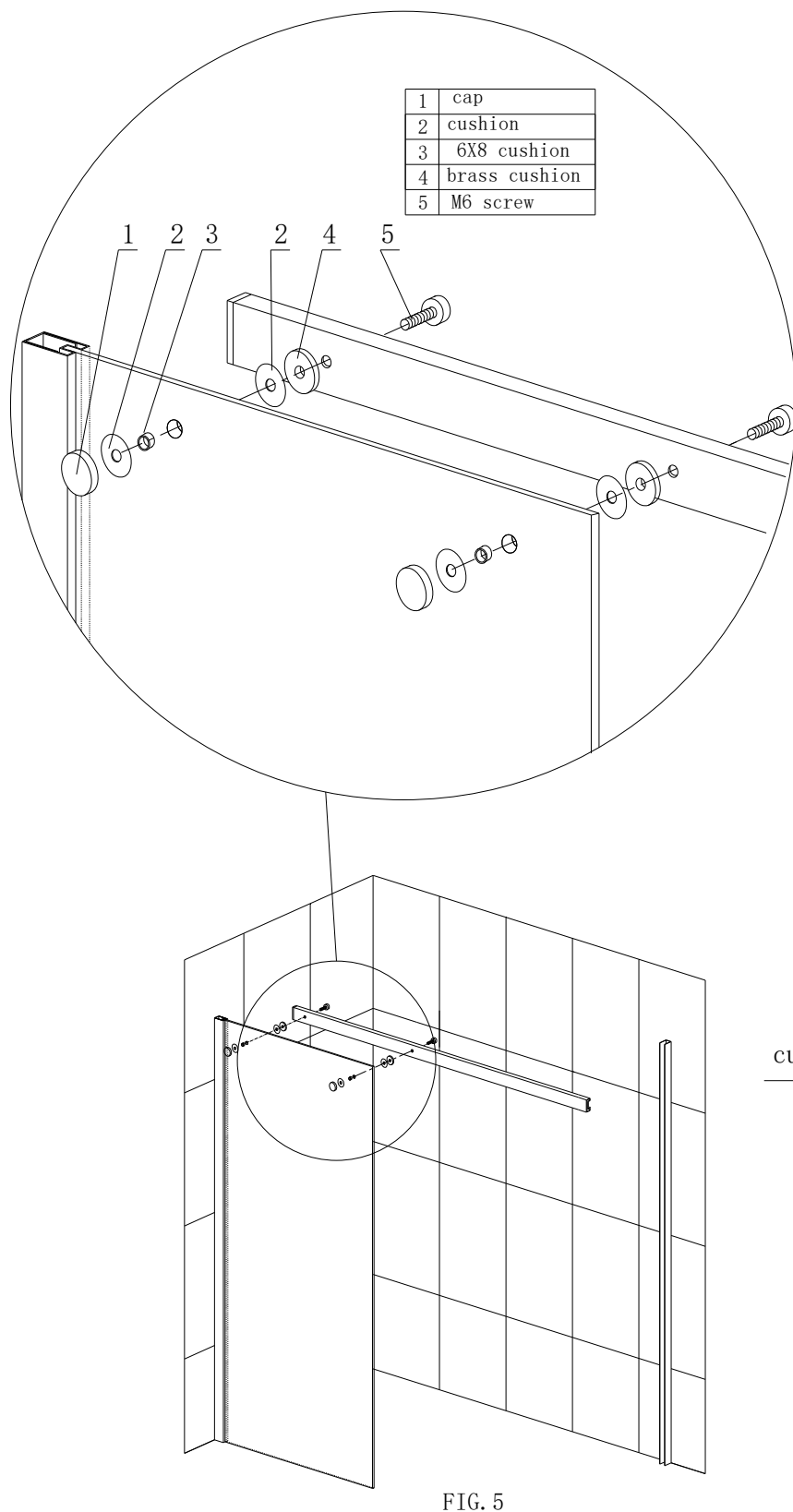

FIG. 5

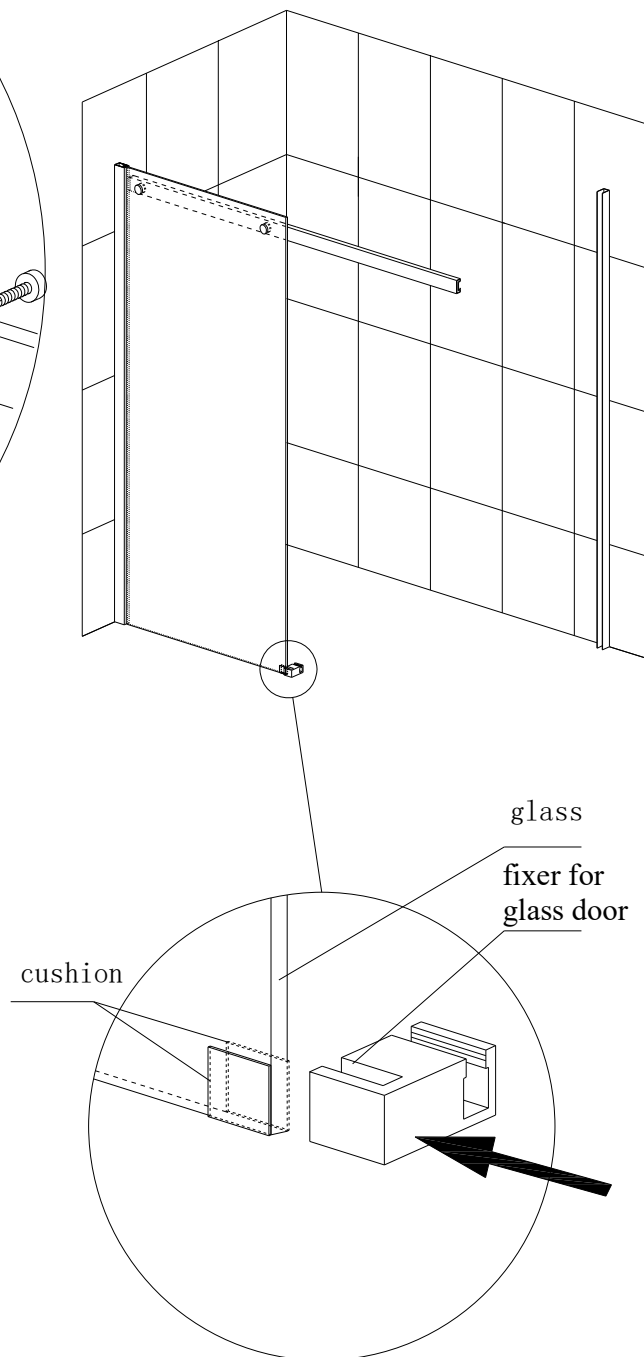
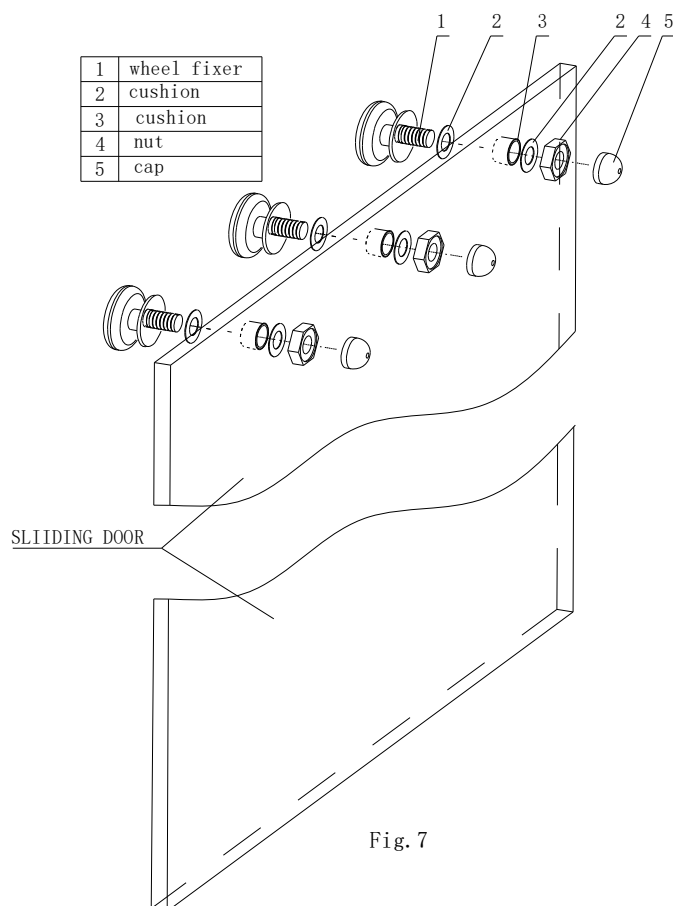
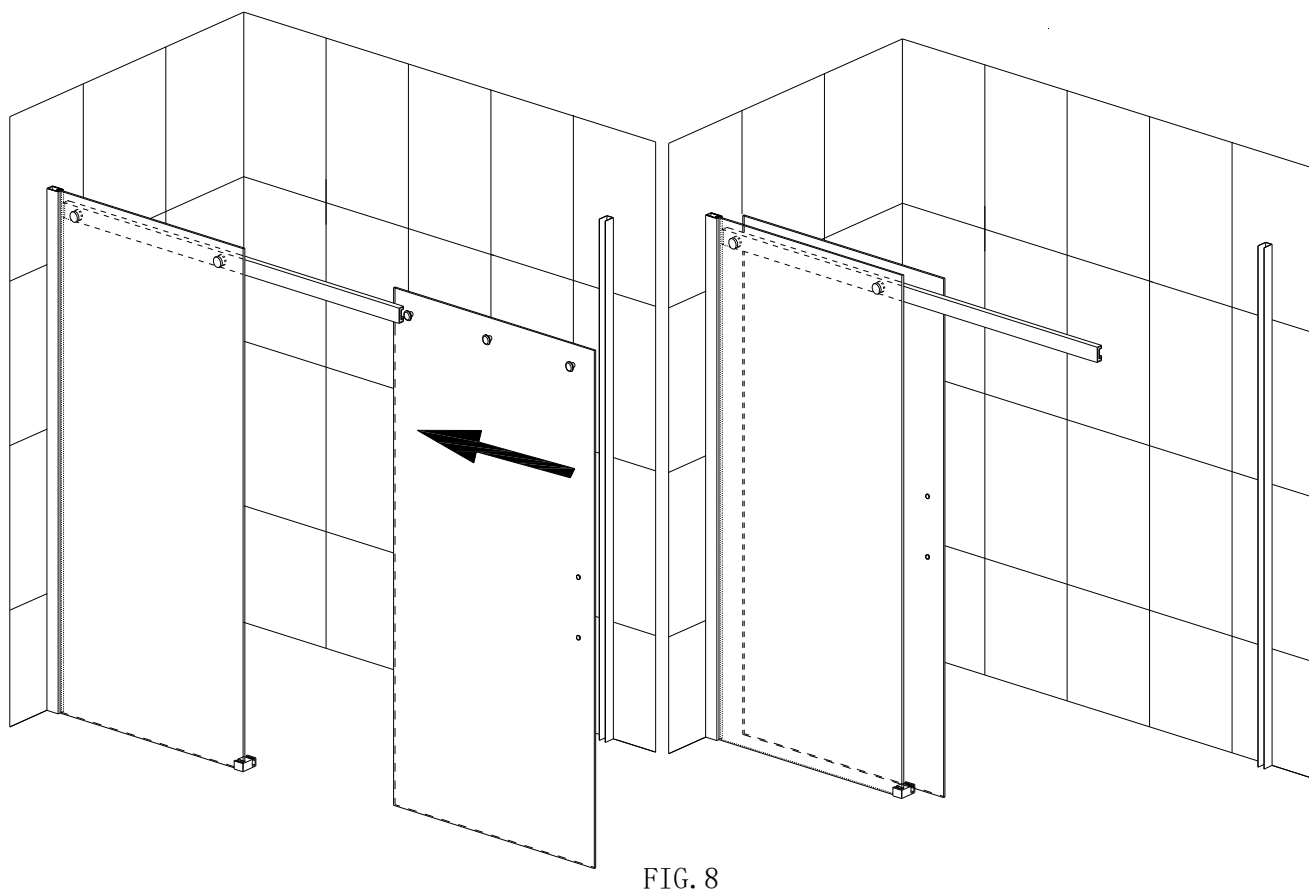

FIG. 6

7) Mount the wheels (14) into the top of sliding door (15). As Fig. 7



8) Put the sliding door with installed wheels into the rail. As Fig. 8



9) Connect the side fixed glass door (22) to the right side wall. As Fig. 9

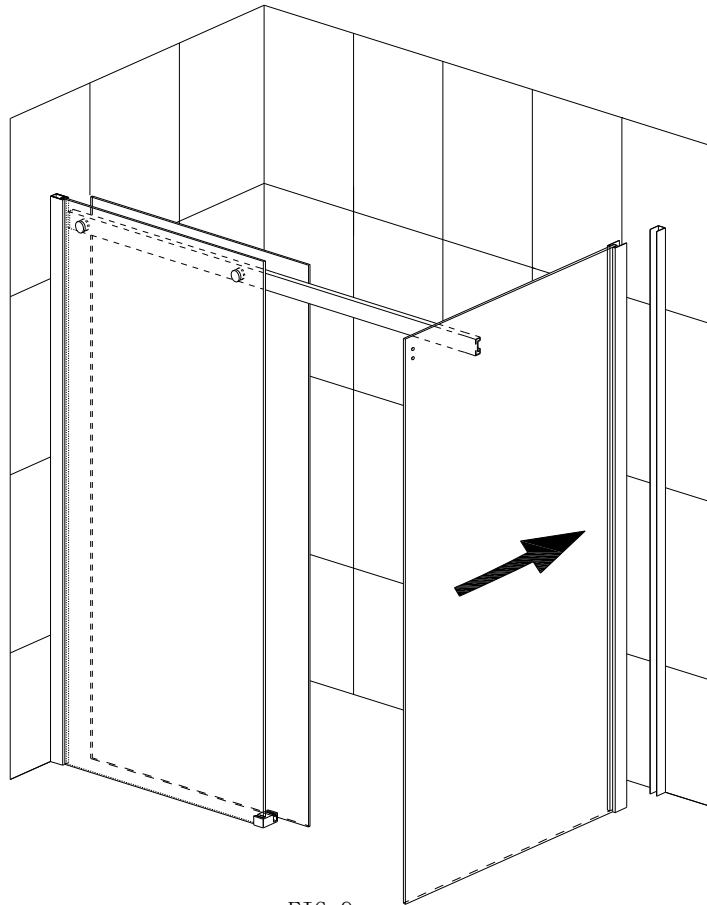

FIG. 9

10) Connect the rail with the side fixed glass door. As Fig. 10

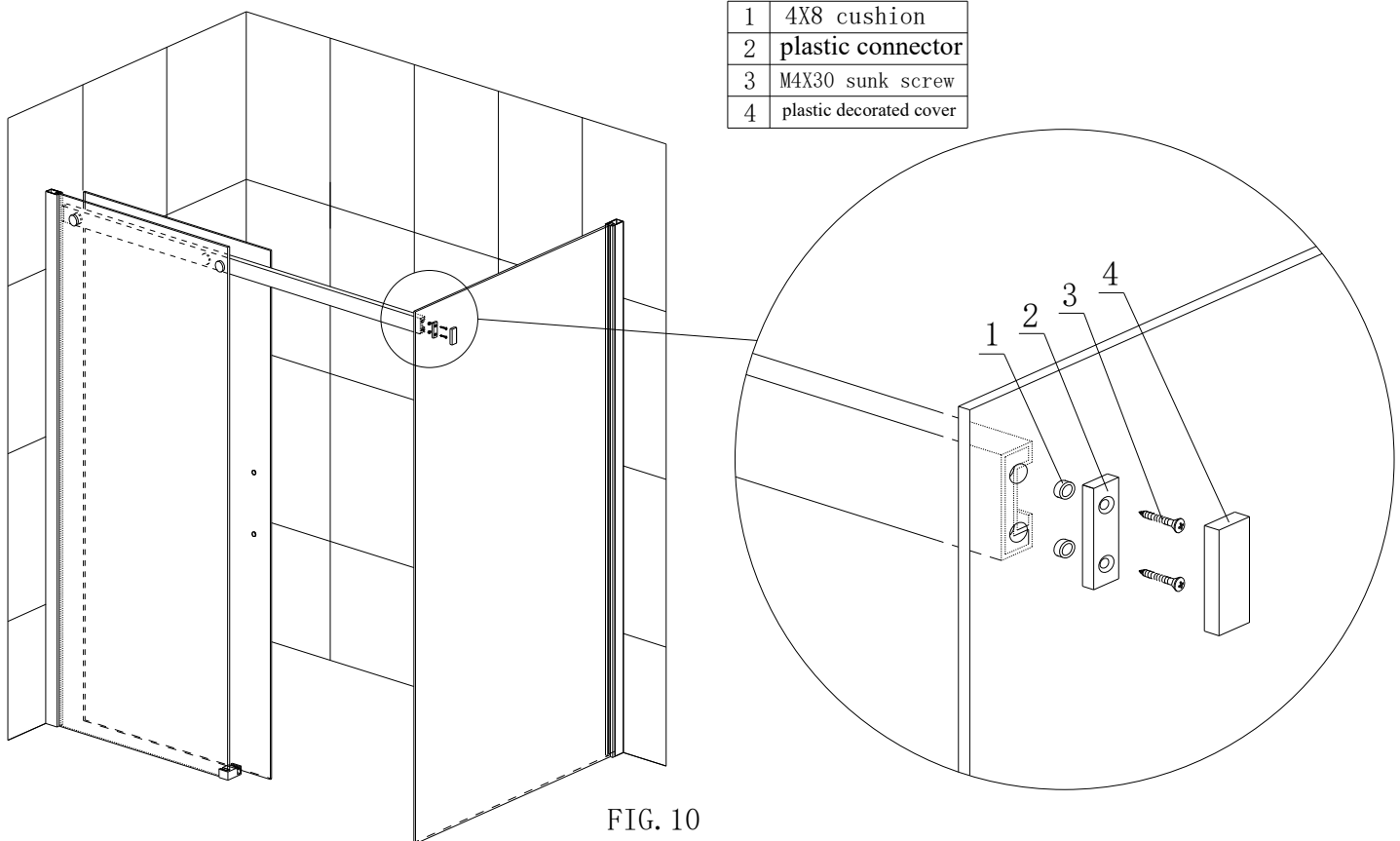

FIG. 10

11) Fix the water proof strips (13) with the front fixed glass door (11), and fix the plastic strip (17) with the sliding door. And then use the M4X10 screws (9) to fix the plastic fixer (8) on the rail. As Fig. 11

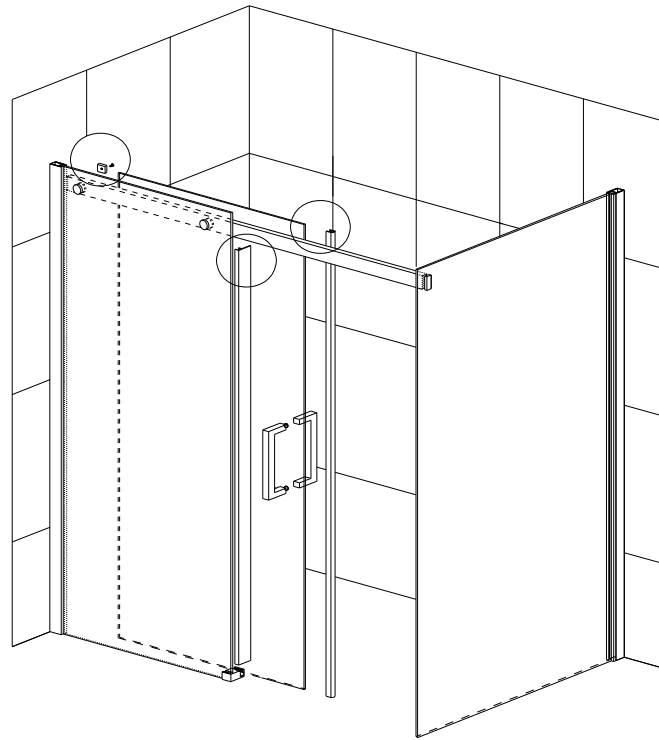

FIG. 11

- 12) Adjust the upper wheels to make sure the sliding doors move smoothly and in good sealing. Drill a hole in $\phi 3.2\text{mm}$ on the connection between fixed door and wall connecting profile. And tighten them by M4x10 (21) screw. As Fig. 12
- 13) Fix the aluminum water proof strip (27) with the glass cement on the floor or on the shower tray. As Fig. 12
- 14) Lay the glass cement between the wall and fixed door profile, and fixed door with floor or shower tray to complete the mounting.

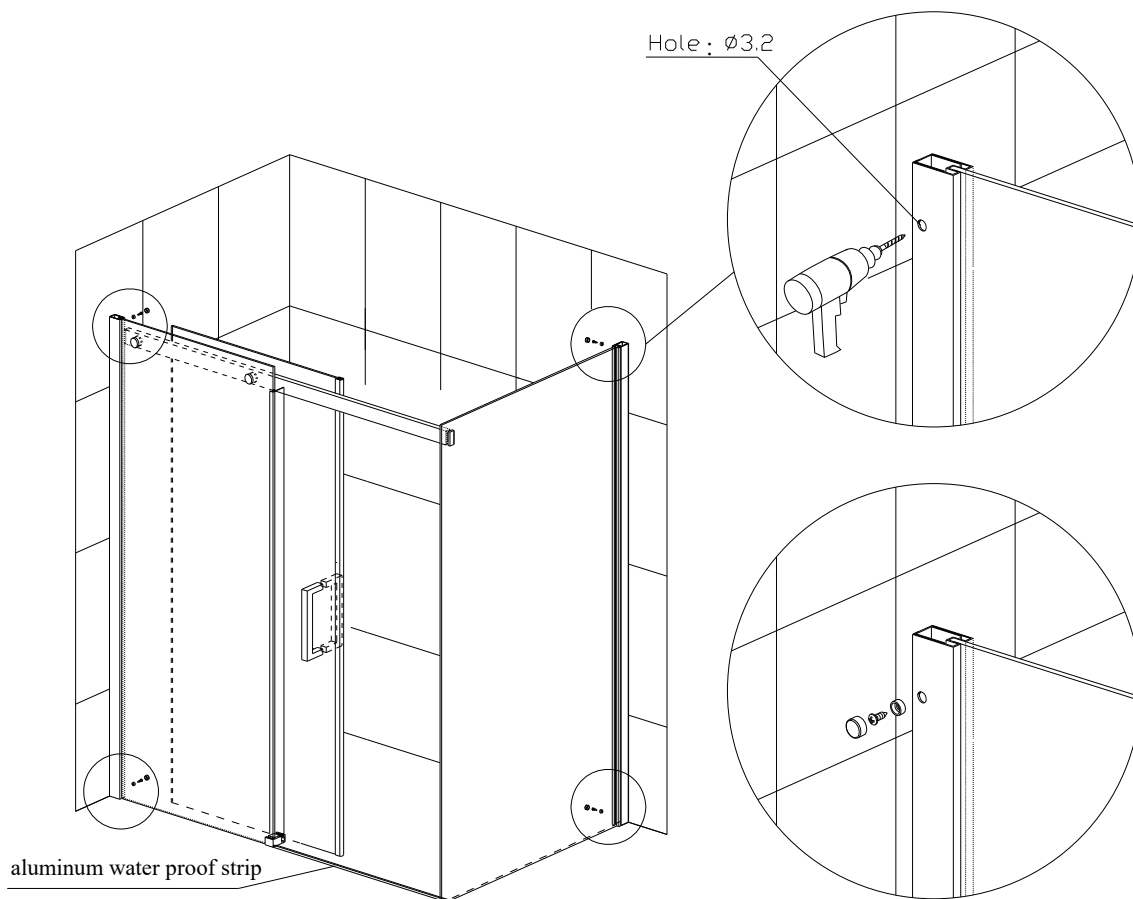

FIG. 12